

FLUOSPOT are small floodlights designed for energy saving compact fluorescent lamps, for indoor and outdoor installation. Very resistant to corrosion, they can be installed in sea side areas.

Body in technopolymer.
Diffuser in U.V. stabilized polycarbonate.
Reflectors in aluminium - External screws in stainless steel. Complete with bracket and cover for wall installation.

Using the available accessories, they can be installed on arm supports, on spike for garden lighting, and on a telescopic support as a work-lamp.

80 85

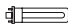

FLUOSPOT PC					
05836013	PC 29	80 CR		G23	2x9W DULUX-S/PL-S
05901023	PC 29	85 CR		G23	2x9W DULUX-S/PL-S

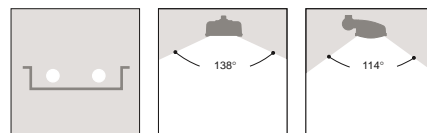

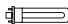
FLUOSPOT PC					
05835013	PC 49	80 CR		G23	4x9W DULUX-S/PL-S
05900023	PC 49	85 CR		G23	4x9W DULUX-S/PL-S
05837013	PC 213	80 CR		G24d-1	2x13W DULUX-D/PL-C
05902023	PC 213	85 CR		G24d-1	2x13W DULUX-D/PL-C

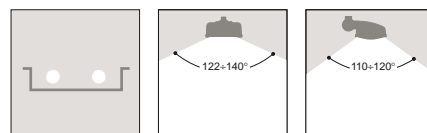

FLUOSPOT PC					
05892013	PC 16 2D	80 CR		2p GR8	16W 2D
05904023	PC 16 2D	85 CR		2p GR8	16W 2D

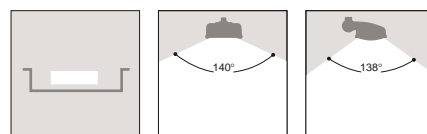

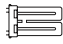
FLUOSPOT PC					
05893013	PC 24F	80 CR		2G10	24W DULUX FLAT
05903023	PC 24F	85 CR		2G10	24W DULUX FLAT

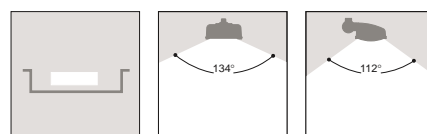

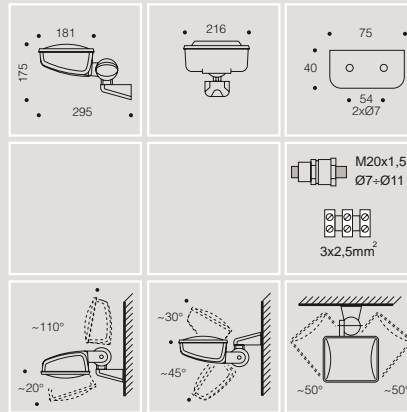

CLASS I			IP 55	
			1 m	850°
IK 09 12J		0.04 m ²	Max 1.7Kg	
	FSD 9W	FSQ 13W	FSS 16W	FSD 24W



FLUOSPOT KIT

03002280	KIT 49	80	CRL		G23	4x9W	DULUX-S/PL-S
03002385	KIT 49	85	CRL		G23	4x9W	DULUX-S/PL-S

Kit fitting+500mm. arm, complete with 4x9W fluorescent lamps.
Available in white or black colour.

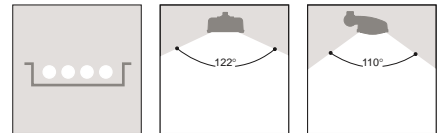

ACCESSORIES

14002680	A0168/500	80	Die cast aluminium control gear box (IP54) with 500 or 1000 mm. arm in black painted steel tube. It allows connection of fittings in series.
14002785	A0168/500	85	
14002880	A0168/1000	80	
14002985	A0168/1000	85	
14004011	A 113/500	80	500 or 1000 mm. support in painted steel tube.
14005021	A 113/500	85	
14323013	A 113/1000/R	80	
14324023	A 113/1000/R	85	
14325016	A0082	80	Galvanized steel spike painted in black for ground fixing.
14337011	A107/T	80	Adjustable telescopic support in painted steel.
14404995	A0108		Set of 100 stainless steel antivandal screws TORX T20H INOX.

MAIN USE: Advertising panels • Outdoor commercial and residential.

